

S5036

07-08 CHEV/GMC 1500, EXTENDED CAB (5'8" & 6'5" BOX)/ CREW CAB SHORT 5'8" BOX/ REGULAR CAB, 4.8L/5.3L/6.0L, CAT BACK, 3.0" SINGLE SIDE EXIT

MBRP®

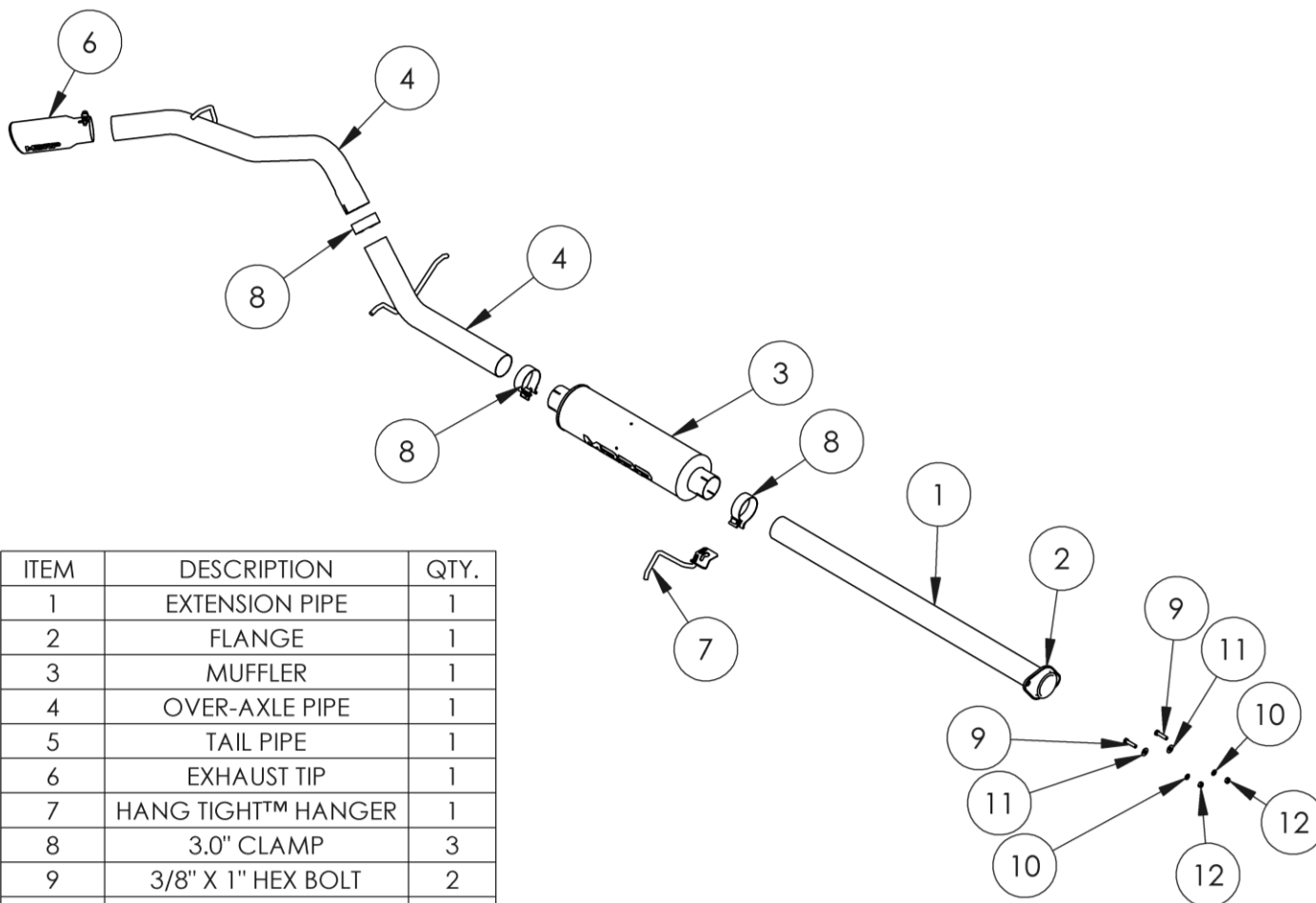

ITEM	DESCRIPTION	QTY.
1	EXTENSION PIPE	1
2	FLANGE	1
3	MUFFLER	1
4	OVER-AXLE PIPE	1
5	TAIL PIPE	1
6	EXHAUST TIP	1
7	HANG TIGHT™ HANGER	1
8	3.0" CLAMP	3
9	3/8" X 1" HEX BOLT	2
10	3/8" LOCK WASHER	2
11	3/8" FLAT WASHER	2
12	3/8" HEX NUT	2

PLEASE READ BEFORE STARTING INSTALLATION

While MBRP Inc. has made every effort to ensure that all components of this system are of superior quality and properly packaged, it is the installer's responsibility to ensure the following before removal of the factory exhaust:

- that ALL components shown above are present.
- that ALL mating components fit together.
- that there are no damaged components.
- that the system you have purchased is appropriate for your vehicle year, model and configuration.
- that the system will not interfere with any modifications previously installed or planned.
- that you have read and understand these instructions.

If you have any questions or are uncertain about any aspect of the installation of this system to your vehicle please contact your dealer before commencing installation.

Removal of stock system:



Figure 1



Figure 2

1. Apply a penetrating lubricant liberally to all exhaust fasteners, hangers and rubber insulators.
2. Remove the nuts from the studs holding the front flange together and disconnect exhaust system. Refer to Figure 1.
3. Remove the hangers from the rubber insulators and remove the exhaust from the vehicle.
4. If a hoist or hydraulic lift is not being used the tail pipe may need to be cut to clear the rear axle. Refer to Figure 2
5. The studs located in the exhaust flange must be removed. This can be accomplished using a hammer. The studs will be replaced by hardware supplied with the system.

Installation of MBRP Ltd. Performance Exhaust:

1. Determine the overall length of the Extension Pipe and cut to length. Refer to below chart.



Figure 3

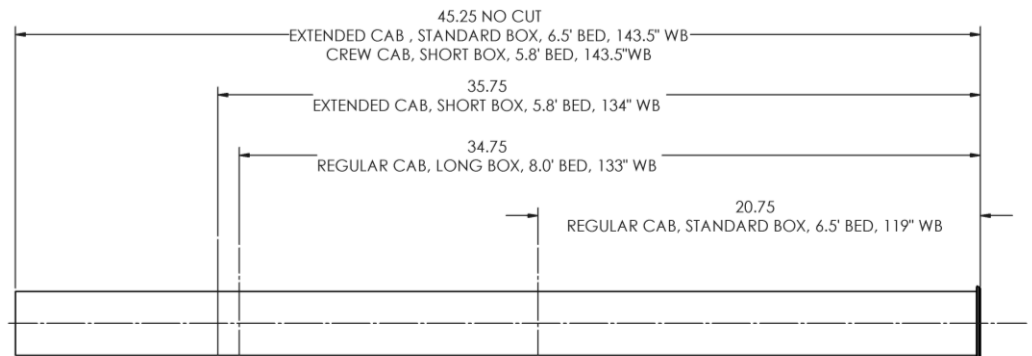

2. Slide over the **Flange** onto the **Extension Pipe** and Loosely attach at the **Flange** end using the hardware provided. **Refer to Figure 3.**

3. Install the **Hang Tight™ Hanger** onto a **3.0" Clamp** using the procedure shown below. (Hang Tight™ Hanger not exactly as Shown).

MBRP®



Figure 4

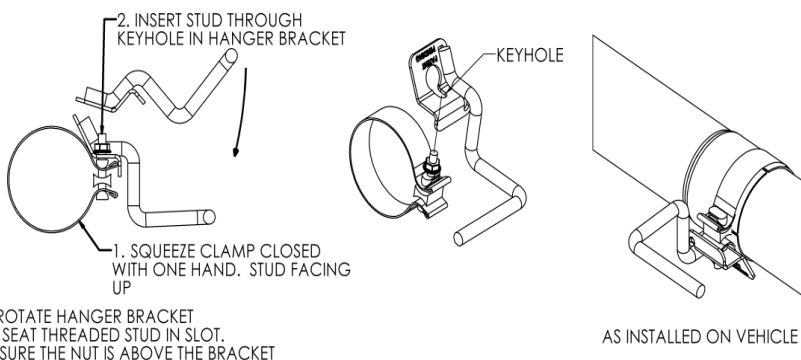

Figure 5

4. Install the **Hang Tight™ Hanger** assembly over the **Muffler** inlet end. Install the **Muffler** onto the **Extension Pipe** and slide the **Hang Tight™ Hanger** into the OEM rubber isolator located on the frame near the **Extension Pipe**.
5. Slide a **3.0" Clamp** onto the rear of the **Muffler** then install the **Over-Axle Pipe** into the **Muffler**. Install the hangers into the factory rubber insulator located above.
Refer to Figure 4.
6. Slide a **3.0" Clamp** onto the rear of the **Over-Axle Pipe**. Feed the **Tail Pipe** over the axle and loosely attach it to the **Over-Axle Pipe**.
7. Install the **Tail Pipe** hanger into the factory rubber insulator located directly above the hanger.
Refer to Figure 5.
8. Install the **Exhaust Tip**.
9. Align the edge of each band clamp with the edge of the joint it is connecting. Tighten all hardware and clamps, starting at the front and working rearward to secure the system. Check along the full length of the exhaust system to ensure there is adequate clearance for fuel lines, vent lines, brake lines, frame, bodywork, suspension, and any wiring, etc. If there is any interference detected, relocate, or adjust to provide adequate clearance. Ensure all clamp connections are secure and components are unable to rotate or slide. Band clamps require approximately 45 lb-ft (60 N-m) of torque. Verify clearances, system security and band clamp torque after 30-60 miles (50-100 km) of driving.



Congratulations! You are ready to begin enjoying the improved performance and driving experience of your MBRP Ltd. Performance Exhaust system. We know you will enjoy your purchase.